

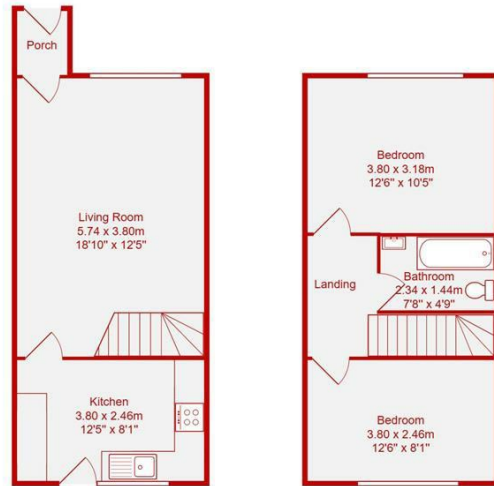

- Terraced House
- Modern Fitted Kitchen
- Garage At The rear
- Good Size Lounge
- Popular Location
- Two Bedrooms
- South Facing Rear Garden
- Rear Access
- Modern Bathroom
- Great Public Transport

Bush Farm Drive, Portslade, Brighton

Price: £325,000 Freehold



Ground Floor
Area: 33.2 m² ... 357 ft²

First Floor
Area: 31.8 m² ... 343 ft²



Total Area: 65.0 m² ... 700 ft²

All measurements are approximate and for display purposes only.

Situated in a popular residential pocket of Portslade, Bush Farm Drive offers a great balance of convenience and community. The area is particularly well-suited to families, with a selection of well-regarded local schools within easy reach, along with nearby parks and green spaces for weekend walks and outdoor time.

Everyday essentials are close at hand, with local shops, supermarkets and amenities all easily accessible, while larger retail options can be found a short drive away in central Portslade and nearby Hove.

For commuters, the location is ideal. Regular bus routes run close by, providing easy access into Brighton city centre, while Portslade mainline station offers direct links to London and along the south coast.

With a friendly neighbourhood feel, practical transport links and everything you need on your doorstep, this is a well-connected and highly convenient place to call home.

Energy Efficiency Rating		Current	Potential
Very energy efficient - lower running costs			
(92 plus) A			
(81-91) B			87
(69-80) C		72	
(55-68) D			
(39-54) E			
(21-38) F			
(1-20) G			
Not energy efficient - higher running costs			
England & Wales		EU Directive 2002/91/EC	

